

DEORE LX Mega-9 Rapidfire Lever  
**SL-M570**  
**SL-M570-G** Gold Version

For Left Hand

For Right Hand

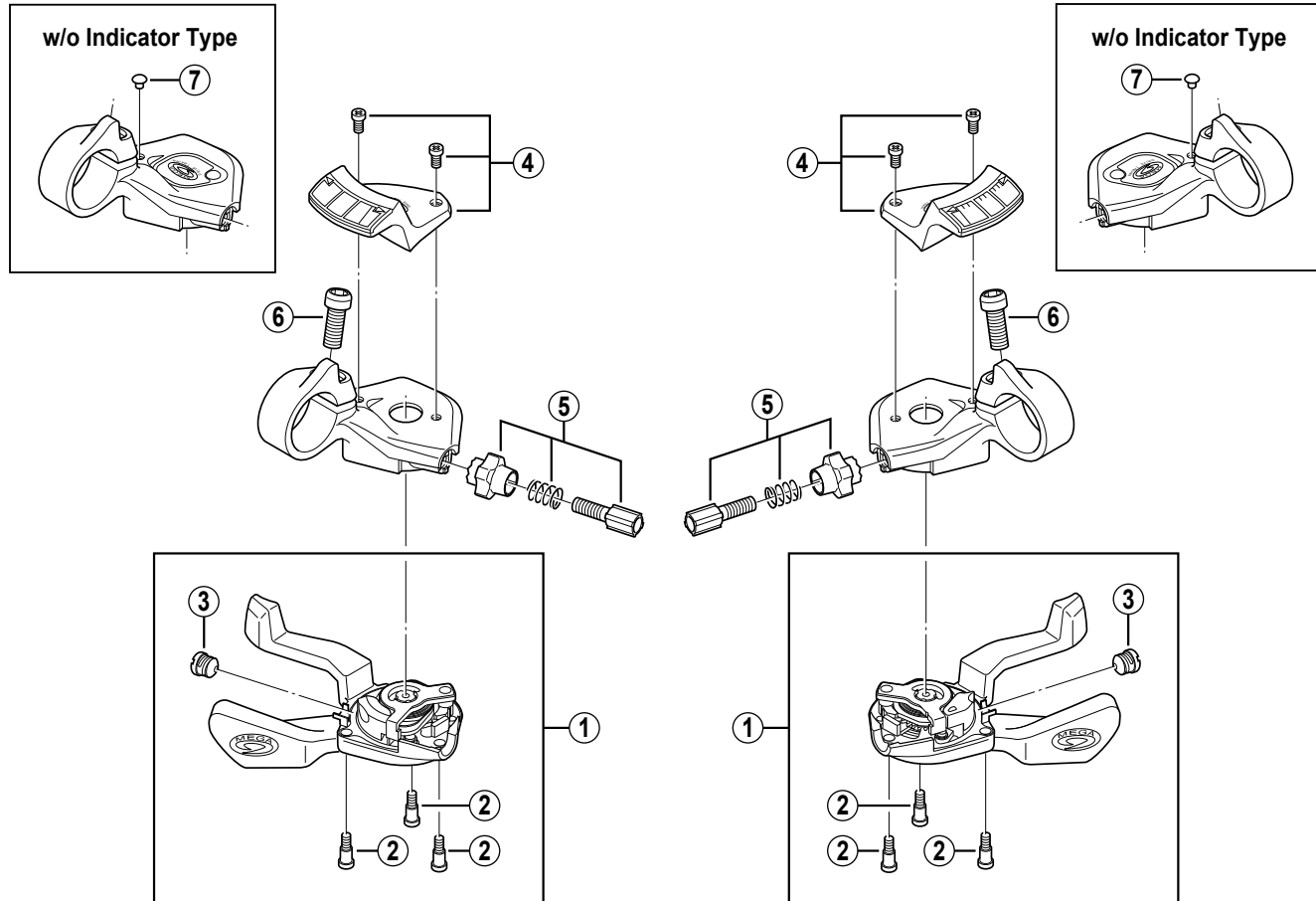

SL-M570

ITEM NO.	SHIMANO CODE NO.	DESCRIPTION	INTERCHANGEABILITY
1	Y-6CD 98010	R.H. Shifting Lever Unit	
	Y-6CD 98020	L.H. Shifting Lever Unit	
	Y-6CD 98080	R.H. Shifting Lever Unit for SL-M570-G	
	Y-6CD 98090	L.H. Shifting Lever Unit for SL-M570-G	
2	Y-6CD 36000	Shifting Lever Unit Fixing Bolt	
3	Y-6CD 33000	Inner Hole Cap	A
4	Y-6CD 98030	R.H. Indicator Unit	B
	Y-6CD 98040	L.H. Indicator Unit	B
	Y-6CD 98100	R.H. Indicator Unit for SL-M570-G	B
	Y-6CD 98120	L.H. Indicator Unit for SL-M570-G	B
5	Y-6CE 98070	Cable Adjusting Bolt Unit	A
6	Y-6AS 50010	Clamp Bolt (M6 x 15)	A
7	Y-6BV 48000	Base Hole Cap	A

A : Same parts.

B : Parts are usable, but differ in materials, appearance, finish, size, etc.

Absence of mark indicates non-interchangeability.

0211-1773B

Specifications are subject to change without notice.

© 2002 by Shimano Inc. 

**SHIMANO**